

# Munters Euroemme MWI

## Modular Wall Inlet

Through its direct correlation with animal health, ideal climate is a critical element in maximising yields, and minimising losses in animal husbandry. Ideal climate is primarily achieved through controlled fresh air entry and optimal air temperature.

### Benefits

- Ensures an optimal flow of fresh air into the house, without exposing livestock to drafts
- Quick user-friendly assembly without added parts
- Smart design and smooth surface finish ensure maximum hygiene
- Modular design ensures a perfect match between the size of inlets, house design and farmer needs
- Recessed curved door channels the air jet along the ceiling and avoids air escape out the sides
- Suitable for quick high pressure washing
- Top quality durable PVC and PP materials, UV stabilized
- Air sealing gaskets at the top and sides to avoid air leakage in closed position

Modular Wall Inlet (MWI) brings fresh air into the house without exposing your animals to cold air drafts. The geometrical shape of MWI has been engineered to channel incoming fresh air along the ceiling, mixing it with the already present indoor air before it reaches the animals.

MWI has been designed to perfectly fit house walls in buildings of any size, thanks to three available widths, and two heights.

The framing system and curved door are manufactured from a combination of UV resistant PVC and PP materials offering maximum durability. MWI can be cleaned with a high pressure washer. For bio-security reasons, an integrated galvanized metal guard is provided, preventing unwanted entry into the house.

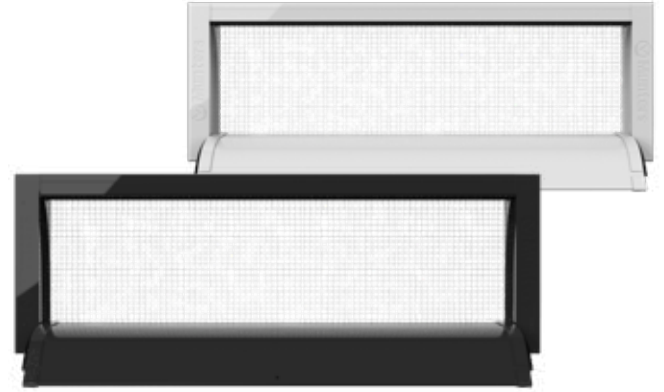

MWI front view



MWI side view

# Munters Euroemme MWI



## Modular Wall Inlet

Healthy animals make profitable farms

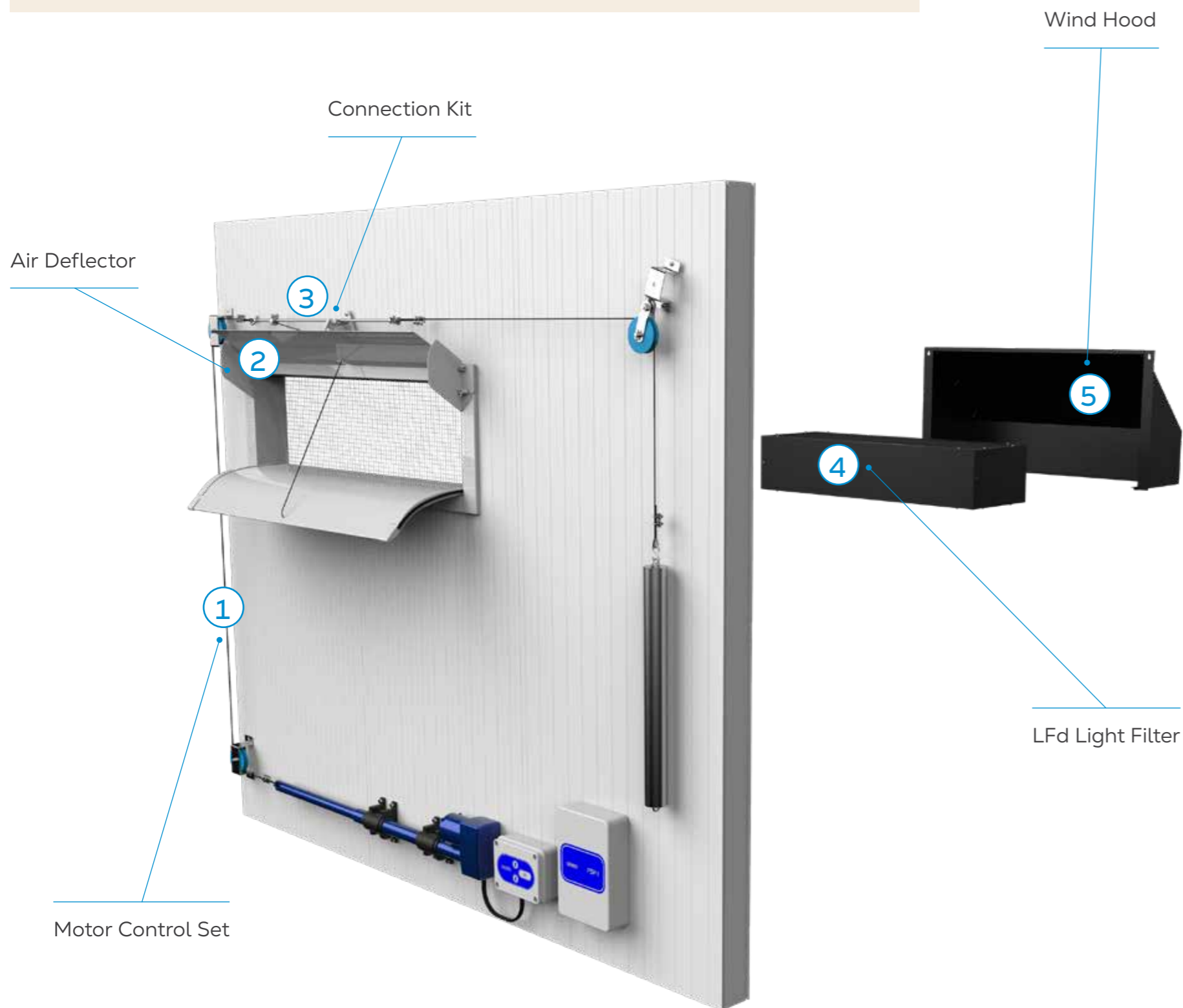
Proper ventilation and a comfortable climate are essential for ensuring animal welfare. Fresh air systems enable effective air exchange and distribution, making them the primary means of achieving optimal indoor conditions. MWI delivers state-of-the-art air intake solutions to support these goals.

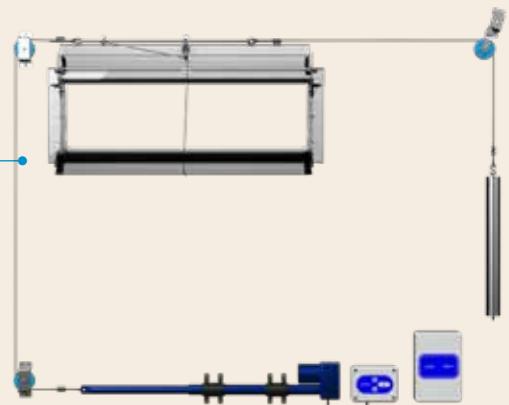
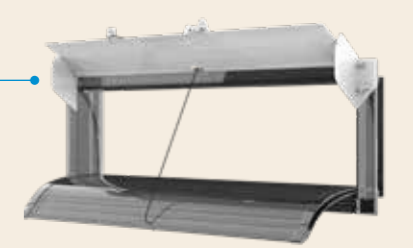
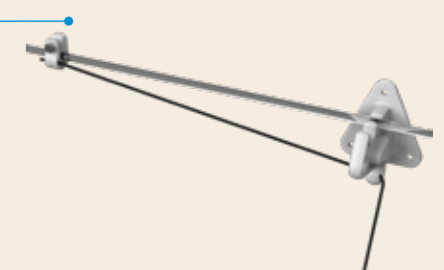
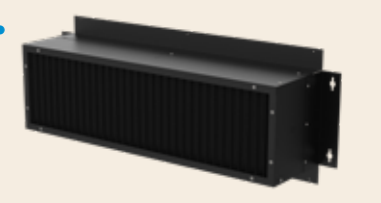

## Available accessories

- 1 Motor Control Set**  
The Motor Control Set allows the optimal regulation of the air inlet system and includes linear actuator LR3000, motor control box SLRK, galvanized pull rods Ø 8 mm, universal pulleys and weight.
- 2 Air Deflector**  
In houses with roofs that have exposed beams, frames, or other obstructions crossing the path of the airflow, the Air Deflector achieves correct air distribution.
- 3 Connection Kit**  
The Connection Kit establishes the connection between the pull rod and fresh air inlet. The kit includes wall guide, cord and clamps for 8 mm pull rod. If used, the Connection Kit must be installed on all fresh air inlets in the house.
- 4 LFd Light Filter**  
The LFd, installed as a wall-mounted cassette, ensures the maximum light dimming effect combined with optimal aerodynamics. Light reduction factor 2.000.000 : 1.
- 5 Wind Hood (canopy)**  
The Wind Hood is designed to protect the farm against rain/snow, and a certain amount of wind, as well as providing a light-dimming effect.

# Munters Euroemme MWI

## Modular Wall Inlet

### Dimensions

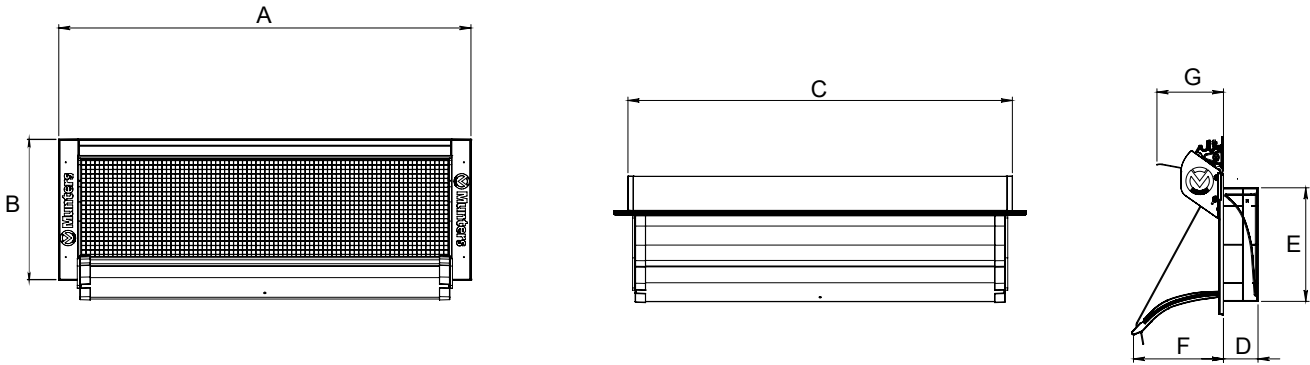

	A	B	C	D	E	F	G <sup>1</sup>
MWI 4413	1,198 mm	410 mm	1,118 mm	100 mm	330 mm	268 mm	194 mm
MWI 4408	1,198 mm	289 mm	1,118 mm	100 mm	210 mm	156 mm	194 mm
MWI 4113	1,122 mm	410 mm	1,041 mm	100 mm	330 mm	268 mm	194 mm
MWI 4108	1,122 mm	289 mm	1,041 mm	100 mm	210 mm	156 mm	194 mm
MWI 3413	944 mm	410 mm	864 mm	100 mm	330 mm	268 mm	194 mm
MWI 3408	944 mm	289 mm	864 mm	100 mm	210 mm	156 mm	194 mm

<sup>1</sup>Air Deflector: optional accessory

### Technical specifications

		MWI 4413	MWI 4408	MWI 4113	MWI 4108	MWI 3413	MWI 3408
Airflow at 10 Pa	m <sup>3</sup> /h	3,597	2,277	3,316	2,175	2,742	1,770
Airflow at 20 Pa	m <sup>3</sup> /h	5,026	3,158	4,716	3,084	3,830	2,491
Airflow at 30 Pa	m <sup>3</sup> /h	6,155	3,867	5,721	3,724	4,671	3,082
Pull force	N	40	20	30	20	20	20
Stroke way	mm	470	290	470	290	470	290

### Load capacity

		MWI 4413	MWI 4408	MWI 4113	MWI 4108	MWI 3413	MWI 3408
20' container	units	900	900	900	900	900	900
40' HC container	units	2,160	2,376	2,160	2,376	2,160	2,376
Box size	cm	112 x 38 x 37.5	112 x 30 x 37.5	104 x 38 x 37.5	104 x 30 x 37.5	88 x 38 x 37.5	88 x 30 x 37.5
Box weight	kg	44	37	41	35	36	31
Pallet size	cm	114 x 118 x 240	114 x 98 x 240	114 x 118 x 240	114 x 98 x 240	90 x 118 x 240	90 x 98 x 240
Pallet weight	kg	800	680	750	640	660	570
Air deflector <sup>1</sup> box size	cm	112 x 38 x 12	112 x 38 x 12	104 x 38 x 12	104 x 38 x 12	88 x 38 x 12	88 x 38 x 12

<sup>1</sup>Air Deflector: optional accessory